

EB T8(G13) Series

LED Lamps T8 (G13)

LED lamps designed to retrofit linear fluorescent lamps

ENERGY LABEL: AMRI AM8EBXXXK, Energy Class A+, XXX kWh/1000h

The energy label features the EU Energy Label logo at the top. Below it, the brand name 'AMRI' and model 'AM8EBXXXK' are listed. A vertical scale of energy efficiency classes from A++ (green) to E (red) is shown, with a large black arrow pointing to the 'A+' class. At the bottom, the energy consumption is indicated as 'XXX kWh/1000h'.

Compatible with Electric Ballast

Easy of use

Direct Replace



Direct Plug and play



AMRI T8 EB Tube Series Features



◆ Direct Replacement.

No need to re-wire the fixture, direct plug-and-play

◆ Compatible with **Electric Ballast(ECG)**

LED tube Parameters same the fluorescent lamp

◆ **Work with Electric Ballast(ECG)**

PF>0.95

NO frequency.

Without increasing the power consumption

◆ Cycles of Operation: 50,000 times
(On 25SEC / Off 30 SEC) .

◆ Up to 50,000 hours service life
with a 5-Year warranty.



No Electrolytic capacitors Inductance

On board, can long life 50000hr



LED Tube Replace fluorescent lamp List

T8 EB FL Series

Length	1.5m	1.2m	0.6m
T8 FL lamp	58W	40/38/36W	20/18W
AMRI LED T8 Series	 22W	 18W	 9W
Energy-Saving	64%	50%	50%
Energy consumption kWh/1000h	22	18	9
CO₂ Abatement(KW)	23.4 kg-CO₂	11.7 kg-CO₂	5.85 kg-CO₂

LED Tube Replace fluorescent lamp List

T8 HF EB Series

Length	1.5m	1.2m	0.6m
T8 HF FL lamp	NA	32W	17/16W
AMRI LED T8 Series	NA	18W	9W
Energy-Saving	NA	44%	44%
Energy consumption kWh/1000h	NA	18	9
CO₂ Abatement(KW)	NA	9.1 kg-CO₂	4.55 kg-CO₂

Product Name: LED T8 2F EB Tube

Product Model: AM8EB2FXXK



Note: Suitable Electronic Ballast

Replace T8(G13) fluorescent lamp 16/17/18W

Item	AM8EB2FXXK-AL
Rated Voltage	In accordance with electric ballast
Rated Current	260~360mA
Rated Power	9W±1W
Fire Protection Class	UL94V-2

- 一、 Packing List: Led T8 2F
- 二、 Replace T8(G13) fluorescent lamp 16/17/18W
- 三、 **No modifications of the luminaire which the LED lamp is to be used with are to be made.**
- 四、 The ambient temperature range $-20^{\circ}\text{C} \sim +60^{\circ}\text{C}$
- 五、 “This lamp is designed for general lighting service (excluding for example explosive atmospheres).”

AMRI EB Tube T8/2F Speciation

Optical Parameters

Model No.	Order No.	Color Temperature	Luminance	Lm/W	CRI	Angles	LED Type	Power
LED T8 2F EB Tube	AM8EB2F30K-GL	3000k	720	80	80	300°	SMD	9W
	AM8EB2F35K-GL	3500k	720	80	80	300°	SMD	9W
	AM8EB2F40K-GL	4000k	765	85	80	300°	SMD	9W
	AM8EB2F50K-GL	5000k	810	90	80	300°	SMD	9W
	AM8EB2F57K-GL	5700k	855	95	80	300°	SMD	9W
	AM8EB2F65K-GL	6500k	900	100	80	300°	SMD	9W

AMRI ENTERPRISE CO., LTD.
 TAIWAN LEADERS CENTER,8FA2
 NO,29 HAI-PIEN ROAD,KAHHSIUNG,TAIWAN,R.O.C
<http://www.amriled.com>
 TEL: 886-7-3353075
 FAX: 886-7-3389030



AMRI EB Tube T8/2F Speciation

Electrical Parameters

Model No.	Order No.	Electrical Parameters			Luminance		
		Low Ballast Factor(0.79)	Normal Ballast Factor(0.9)	High Ballast Factor(1.15)	Low Ballast Factor(0.79)	Normal Ballast Factor(0.9)	High Ballast Factor(1.15)
LED T8 2F EB Tube	AM8EB2F30K-GL	7.5	9	11	700	720	850
	AM8EB2F35K-GL	7.5	9	11	700	720	850
	AM8EB2F40K-GL	7.5	9	11	730	765	900
	AM8EB2F50K-GL	7.5	9	11	780	810	930
	AM8EB2F57K-GL	7.5	9	11	810	855	950
	AM8EB2F65K-GL	7.5	9	11	850	900	1000

AMRI ENTERPRISE CO., LTD.
 TAIWAN LEADERS CENTER,8FA2
 NO,29 HAI-PIEN ROAD,KAHHSIUNG,TAIWAN,R.O.C
<http://www.amriled.com>
 TEL: 886-7-3353075
 FAX: 886-7-3389030



Product Name: LED T8 4F EB Tube

Product Model: AM8EB4FXXK



Note: Suitable Electronic Ballast

Replace T8(G13) fluorescent lamp 32/36/38 W

Item	AM8EB4FXXK-AL
Rated Voltage	In accordance with electric ballast
Rated Current	260~360mA
Rated Power	18W±1W
Fire Protection Class	UL94V-2

- 一、 Packing List: Led T8 4F
- 二、 Replace T8(G13) fluorescent lamp 32/36/38 W
- 三、 **No modifications of the luminaire which the LED lamp is to be used with are to be made.**
- 四、 The ambient temperature range $-20^{\circ}\text{C} \sim +60^{\circ}\text{C}$
- 五、 “This lamp is designed for general lighting service (excluding for example explosive atmospheres).”

AMRI EB Tube T8/4F Speciation

Optical Parameters

Model No.	Order No.	Color Temperature	Luminance	Lm/W	CRI	Angles	LED Type	Power
LED T8 4F EB Tube	AM8EB4F30K-GL	3000k	1500	80	80	300°	SMD	18W
	AM8EB4F35K-GL	3500k	1500	80	80	300°	SMD	18W
	AM8EB4F40K-GL	4000k	1550	85	80	300°	SMD	18W
	AM8EB4F50K-GL	5000k	1620	90	80	300°	SMD	18W
	AM8EB4F57K-GL	5700k	1750	95	80	300°	SMD	18W
	AM8EB4F65K-GL	6500k	1800	100	80	300°	SMD	18W

AMRI ENTERPRISE CO., LTD.
 TAIWAN LEADERS CENTER,8FA2
 NO,29 HAI-PIEN ROAD,KAHHSIUNG,TAIWAN,R.O.C
<http://www.amriled.com>
 TEL: 886-7-3353075
 FAX: 886-7-3389030



AMRI EB Tube T8/4F Speciation

Electrical Parameters

Model No.	Order No.	Electrical Parameters			Luminance		
		Low Ballast Factor(0.79)	Normal Ballast Factor(0.9)	High Ballast Factor(1.15)	Low Ballast Factor(0.79)	Normal Ballast Factor(0.9)	High Ballast Factor(1.15)
<u>LED T8</u> <u>4F</u> <u>EB Tube</u>	AM8EB4F30K-GL	16.5	18	20	1420	1500	1650
	AM8EB4F35K-GL	16.5	18	20	1420	1500	1650
	AM8EB4F40K-GL	16.5	18	20	1450	1550	1690
	AM8EB4F50K-GL	16.5	18	20	1550	1620	1760
	AM8EB4F57K-GL	16.5	18	20	1600	1750	1880
	AM8EB4F65K-GL	16.5	18	20	1700	1800	1930

AMRI ENTERPRISE CO., LTD.
 TAIWAN LEADERS CENTER,8FA2
 NO,29 HAI-PIEN ROAD,KAOHSIUNG,TAIWAN,R.O.C
<http://www.amriled.com>
 TEL: 886-7-3353075
 FAX: 886-7-3389030



Product Name: LED T8 5F EB Tube

Product Model: AM8EB5FXXK



Note: Suitable AC In/EB/EM

Replace T8(G13) fluorescent lamp 58 W

Item	AM8EB5FXXK-GL
Rated Voltage	In accordance with electric ballast
Rated Current	450~500mA
Rated Power	24W±1W
Fire Protection Class	UL94V-2

- 一、 Packing List: Led T8 5F
- 二、 Replace T8(G13) fluorescent lamp 58W
- 三、 **No modifications of the luminaire which the LED lamp is to be used with are to be made.**
- 四、 The ambient temperature range $-20^{\circ}\text{C} \sim +60^{\circ}\text{C}$
- 五、 “This lamp is designed for general lighting service (excluding for example explosive atmospheres).”

AMRI EB Tube T8 1.5M Speciation

Optical Parameters

Model No.	Order No.	Color Temperature	Luminance	Lm/W	CRI	Angles	LED Type	Power
LED T8 5F EB Tube	AM8EB4F30K-PL	3000k	1680	80	80	300°	SMD	22W
	AM8EB4F35K-PL	3500k	1680	80	80	300°	SMD	22W
	AM8EB4F40K-PL	4000k	1785	85	80	300°	SMD	22W
	AM8EB4F50K-PL	5000k	1890	90	80	300°	SMD	22W
	AM8EB4F57K-PL	5700k	2000	95	80	300°	SMD	22W
	AM8EB4F65K-PL	6500k	2100	100	80	300°	SMD	22W

AMRI ENTERPRISE CO., LTD.
 TAIWAN LEADERS CENTER,8FA2
 NO,29 HAI-PIEN ROAD,KAOSIUNG,TAIWAN,R.O.C
<http://www.amriled.com>
 TEL: 886-7-3353075
 FAX: 886-7-3389030



Graphical instruction

Schematic steps of removing a fluorescent lamp and inserting LED lamp



Switch off electricity.

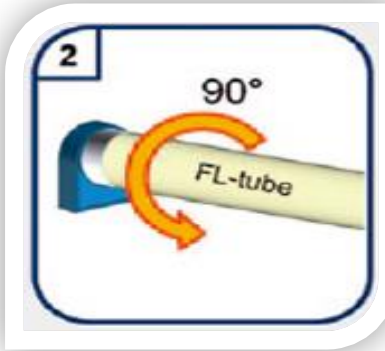

Secure the position by turning the lamp by 90° .



Remove the conventional lamp.



Insert the LED lamp into the lamp holder.



Secure the position by turning the lamp by 90° .



Switch on electricity and check for lamp starting.

Note:



**Lamp suitable for
Electronic Ballast**



**Lamp not suitable for emergency
operation**

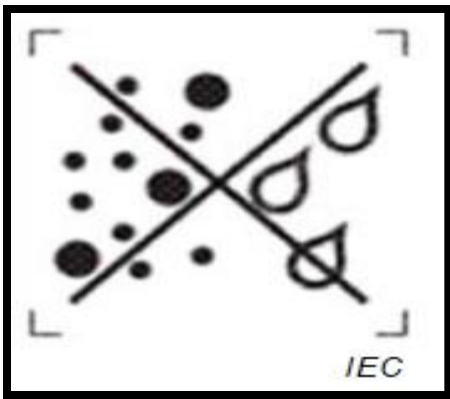

**Lamp to be used in dry conditions
or in a luminaire that provides
protection**



Dimming not allowed



Package

Product Name	(PCSCTN)	(G.W.)	(mm)
T8 2ft	30 PCS	6.5 KG	L640 * W260 *H230
T8 4ft	30 PCS	11.5 KG	L1240 * W260 *H230
T8 5ft	30 PCS	9 KG	L1545 * W210 *H185
T5 2 ft	50 PCS	5.5 KG	L580 * W220 *H210
T5 3ft	50 PCS	8.5 KG	L885 * W215 *H215
T5 4ft	50 PCS	10.5 KG	L1180 * W220 * H130
T5 5ft	50 PCS	14 KG	L1485 * W215 * H215

Mechanical Parameters

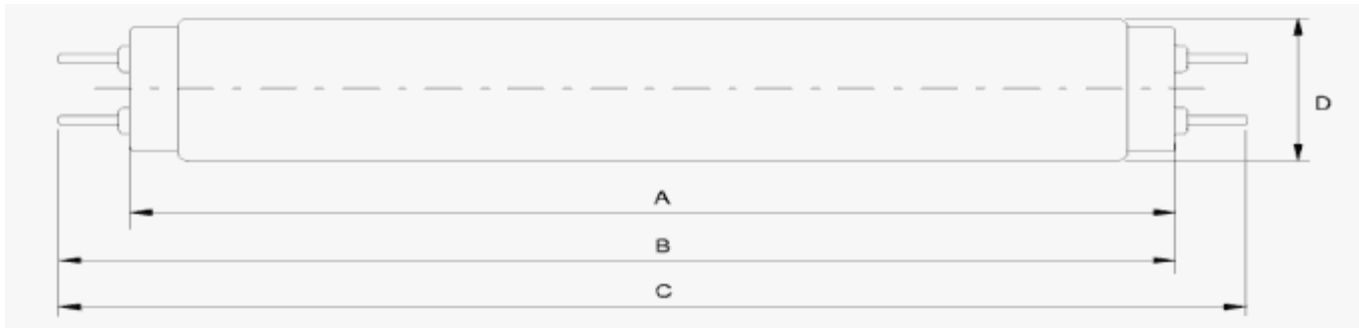

	A	B		C	D
	Max.	Min.	Max.	Max.	Max.
G13----T8					
T8-600	589.8	594.5	596.9	604.0	28.0
T8-900	894.6	899.3	901.7	908.8	28.0
T8-1200	1199.4	1204.1	1206.5	1213.6	28.0
T8-1500	1500.0	1504.7	1507.1	1514.2	28.0

LED T8/T5 TUBE EB SERIES

Application

Supermarket



Hospital



Office



School



Factory



Public transit

